

4 **A DECLARATORY RESOLUTION designating an**
5 **“Economic Revitalization Area” under I.C. 6-1.1-**
6 **12.1 for property commonly known as 2100 W.**
7 **State Blvd., Fort Wayne, Indiana 46808 (Dana**
8 **Light Axle Products, LLC)**

9 **WHEREAS**, Petitioner has duly filed its petition dated May 6, 2013 to have the
10 following described property designated and declared an “Economic Revitalization Area”
11 under Sections 153.13-153.24 of the Municipal Code of the City of Fort Wayne, Indiana, and
12 I.C. 6-1.1-12.1, to wit:

13 **Attached hereto as “Exhibit A” as if a part herein;**

14 and

15 **WHEREAS**, said project will create two full-time, permanent jobs for a total new
16 annual payroll of \$150,000, with the average new annual job salary being \$75,000 and retain
17 468 full-time, permanent jobs for a current annual payroll of \$23,876,435, with the average
18 current annual job salary being \$51,018; and

19 **WHEREAS**, the total estimated project cost is \$6,500,000, and

20 **WHEREAS**, it appears the said petition should be processed to final determination in
21 accordance with the provisions of said Division 6.

22 **NOW, THEREFORE, BE IT RESOLVED BY THE COMMON COUNCIL OF THE**
23 **CITY OF FORT WAYNE, INDIANA:**

24 **SECTION 1.** That, subject to the requirements of Section 6, below, the
25 property hereinabove described is hereby designated and declared an “Economic
26 Revitalization Area” under I.C. 6-1.1-12.1. Said designation shall begin upon the effective
27 date of the Confirming Resolution referred to in Section 6 of this Resolution and shall
28 terminate on December 31, 2016, unless otherwise automatically extended in five year
29 increments per I.C. 6-1.1-12.1-9.

30 **SECTION 2.** That, upon adoption of the Resolution:

(a) Said Resolution shall be filed with the Allen County Assessor;

(b) Said Resolution shall be referred to the Committee on Finance requesting a
recommendation from said committee concerning the advisability of designating
the above area an “Economic Revitalization Area”;

(c) Common Council shall publish notice in accordance with I.C. 6-1 1-12.1-2.5 and
I.C. 5-3-1 of the adoption and substance of this resolution and setting this
designation as an “Economic Revitalization Area” for public hearing,

1 **SECTION 3.** That, said designation of the hereinabove described property as an
2 "Economic Revitalization Area" shall apply to a deduction of the assessed value of personal
3 property for new manufacturing equipment.

4 **SECTION 4.** That, the estimate of the number of individuals that will be employed
5 or whose employment will be retained and the estimate of the annual salaries of those
6 individuals and the estimate of the value of new manufacturing equipment, all contained in
7 Petitioner's Statement of Benefits, are reasonable and are benefits that can be reasonably
8 expected to result from the proposed described installation of new manufacturing equipment.

9 **SECTION 5.** That, the current year approximate tax rates for taxing units within
10 the City would be:

11 (a) If the proposed new manufacturing equipment is not installed, the approximate
12 current year tax rates for this site would be \$3.3124/\$100.

13 (b) If the proposed new manufacturing equipment is installed and no deduction is
14 granted, the approximate current year tax rate for the site would be
15 \$3.3124/\$100 (the change would be negligible).

16 (c) If the proposed new manufacturing equipment is installed and a deduction
17 percentage of eighty percent (80%) is assumed, the approximate current year
18 tax rate for the site would be \$3.3124/\$100 (the change would be negligible).

19 **SECTION 6.** That, this Resolution shall be subject to being confirmed, modified
20 and confirmed, or rescinded after public hearing and receipt by Common Council of the
21 above described recommendations and resolution, if applicable.

22 **SECTION 7.** That, pursuant to I.C. 6-1.1-12.1, it is hereby determined that the
23 deduction from the assessed value of the new manufacturing equipment shall be for a period
24 of ten years.

25 **SECTION 8.** That, the benefits described in the Petitioner's Statement of Benefits
26 can be reasonably expected to result from the project and are sufficient to justify the
27 applicable deductions.

28 **SECTION 9.** That, the taxpayer is non-delinquent on any and all property tax due
29 to jurisdictions within Allen County, Indiana.

30 **SECTION 10.** That, pursuant to I.C. 6-1.1-12.1-12 et al, any property owner that
has received a deduction under section 3 or 4.5 of said chapter may be required to repay the
deduction amount as determined by the county auditor in accordance with section 12 of said
chapter if the property owner ceases operations at the facility for which the deduction was
granted and if the Common Council finds that the property owner obtained the deduction by
intentionally providing false information concerning the property owner's plans to continue
operation at the facility.

MAY 06 2013



COMMUNITY DEVELOPMENT
ECONOMIC REVITALIZATION AREA APPLICATION
CITY OF FORT WAYNE, INDIANA

APPLICATION IS FOR: (Check appropriate box(es))

- Real Estate Improvements
- Personal Property Improvements
- Vacant Commercial or Industrial Building

Total cost of real estate improvements:
 Total cost of manufacturing equipment improvements: \$ 6,500,000
 Total cost of research and development equipment improvements:
 Total cost of logistical distribution equipment improvements:
 Total cost of information technology equipment improvements:
TOTAL OF ABOVE IMPROVEMENTS: \$ 6,500,000

GENERAL INFORMATION

Real property taxpayer's name: Dana Light Axle Products LLC
 Personal property taxpayer's name: Dana Light Axle Products LLC
 Telephone number: 419-866-2649
 Address listed on tax bill: 2100 W State Blvd., Fort Wayne, Indiana 46808
 Name of company to be designated, if applicable: Dana Light Axle Products LLC
 Year company was established: Facility Built 1945-1970
 Address of property to be designated: 2100 W State Blvd., Fort Wayne, Indiana 46808
 Real estate property identification number: Multiple parcels see Exhibit "C"
 Contact person name: Cheri Gillum, Tax Analyst
 Contact person telephone number: (419) 866-2649 Contact person Email: cheri.gillum@dana.com
 Contact person address: 6201 Trust Drive, Holland, OH 43528

List company officer and/or principal operating personnel

NAME	TITLE	ADDRESS	PHONE NUMBER
Rodney R Filcek	Director	6201 Trust Drive, Holland OH 43528	(419) 866-2592
Mark E Wallace	Director and President	One Village Center, Van Buren Twp, MI 4811	(419) 877-3128
Lillian Etz Korn	Treasurer	One Village Center, Van Buren Twp, MI 4811	(419) 887-5160
Timothy Kraus	Assistant Treasurer	One Village Center, Van Buren Twp, MI 4811	(419) 887-5402
Marc S Levin	Secretary	3939 Technology Drive, Maumee, OH 43537	(419) 887-5440

List all persons or firms having ownership interest in the applicant business and the percentage each holds:

NAME	PERCENTAGE
Dana Automotive Systems Group LLC	100%

Yes No Are any elected officials shareholders or holders of any debt obligation of the applicant or operating business? If yes, who? (name/title)

Yes No Is the property for which you are requesting ERA designation totally within the corporate limits of the City of Fort Wayne?

Yes No Do you plan to request state or local assistance to finance public improvements?

Yes No Is the property for which you are requesting ERA designation located in an Economic Development Target Area (EDTA)? (see attached map for current areas)

Yes No Does the company's business include a retail component? If yes, answer the following questions:

What percentage of floor space will be utilized for retail activities?

What percentage of sales is made to the ultimate customer?

What percentage of sales will be from service calls?

What is the percentage of clients/customers served that are located outside of Allen County? 100%

What is the company's primary North American Industrial Classification Code (NAICs)? 336310

Describe the nature of the company's business, product, and/or service:

Industrial Use-Automotive Parts Manufacturer

Dollar amount of annual sales for the last three years:

Year	Annual Sales
2012	\$210,867,782
2011	\$ 168,572,270
2010	\$ 160,946,198

List the company's three largest customers, their locations and amount of annual gross sales:

Customer Name	City/State	Annual Gross Sales
Dana Light Axle Manufacturing LLC	Dry Ridge, Kentucky	\$ 180,841,104
Dana Driveshaft Manufacturing LLC	Auburn Hills, Michigan	\$ 12,190,075
Dana Commercial Vehicle Manufacturing LLC	Henderson, Kentucky	\$ 4,564,231

List the company's three largest material suppliers, their locations and amount of annual purchases:

Supplier Name	City/State	Annual Gross Purchases
US Manufacturing Corporation	Warren, Michigan	\$ 25,316,122
Grede LLC	Chicago, Illinois	\$ 16,659,702
Prestrite Corporation	Cleveland, OH	\$ 7,747,556

List the company's top three competitors:

Competitor Name	City/State
GKN plc	Worcestershire, UK
American Axle & Manufacturing Holdings Inc	Detroit, MI
Magna International	Ontario Canada

Describe the product or service to be produced or offered at the project site:

Industrial Use- Automotive Parts Manufacturer

In order to be considered an Economic Revitalization Area (ERA), the area must be within the corporate limits of the City of Fort Wayne and must have become undesirable for, or impossible of, normal development and occupancy because of a lack of development, cessation of growth, deterioration of improvements or character of occupancy, age, obsolescence, substandard buildings, or other factors which have impaired values or prevent a normal development of property or use of property. It also includes any area where a facility or group of facilities that are technologically, economically, or energy obsolete is located and where the obsolescence may lead to a decline in employment and tax revenues.

How does the property for which you are requesting designation meet the above definition of an ERA?

Dana is located within the corporate limits of the City of Fort Wayne and the area has experienced a lack of any significant development for a number of years.

REAL PROPERTY INFORMATION

Complete this section of the application if you are requesting a deduction from assessed value for real property improvements.

Describe any structure(s) that is/are currently on the property:

The subject property is a single-tenant industrial manufacturing/warehouse facility consisting of structural steel framing with masonry and concrete encasement.

Describe the condition of the structure(s) listed above:

The condition is typical for a building built in 1945 with additions up through 1970.

Describe the improvements to be made to the property to be designated for tax phase-in purposes:

N/A

Projected construction start (month/year): N/A

Projected construction completion (month/year): N/A

Yes No Will construction result in Leadership in Energy and Environmental Design (LEED) certification by the U.S. Green Building Council? N/A

Yes No Will construction use techniques to minimize impact on combined sewer overflows? (i.e. rain gardens, bio swales, etc.) N/A

PERSONAL PROPERTY INFORMATION

Complete this section of the application if you are requesting a deduction from assessed value of new manufacturing, research and development, logistical distribution or information technology equipment.

List below the equipment for which you are seeking an economic revitalization area designation.

Manufacturing equipment must be used in the direct production, manufacture, fabrication, assembly, extraction, mining, processing, refining, or finishing of other tangible personal property at the site to be designated. Research and development equipment consists of laboratory equipment, research and development equipment, computers and computer software, telecommunications equipment or testing equipment used in research and development activities devoted directly and exclusively to experimental or laboratory research and development for new products, new uses of existing products, or improving or testing existing products at the site to be designated. Logistical distribution equipment consists of racking equipment, scanning or coding equipment, separators, conveyors, fork lifts or lifting equipment, transitional moving equipment, packaging equipment, sorting and picking equipment, software for technology used in logistical distribution, is used for the storage or distribution of goods, services, or information. Information technology equipment consists of equipment, including software used in the fields of information processing, office automation, telecommunication facilities and networks, informatics, network administration, software development and fiber optics: (use additional sheets, if necessary)

See Exhibit "D"

Yes No Has the above equipment for which you are seeking a designation, ever before been used for any purpose in Indiana? If yes, was the equipment acquired at an arms length transaction from an entity not affiliated with the applicant? Yes No

Yes No Will the equipment be leased?

Date first piece of equipment will be purchased (month/year): See Exhibit "D"

Date last piece of equipment will be installed (month/year): See Exhibit "D"

Please provide the depreciation schedule term for equipment under consideration for personal property tax phase-in:

See Exhibit "D"

ELIGIBLE VACANT BUILDING INFORMATION

Complete this section of the application if you are requesting a deduction from the current assessed value of a vacant building

Yes No Has the building for which you are seeking designation for tax phase-in been unoccupied for at least one year? Please provide evidence of occupation. (i.e. certificate of occupancy, paid utility receipts, executed lease agreements)

Describe any structure(s) that is/are currently on the property:

N/A

Describe the condition of the structure(s) listed above: N/A

Projected occupancy date (month/year): N/A

Describe the efforts of the owner or previous owner in regards to selling, leasing or renting the eligible vacant building during the period the eligible vacant building was unoccupied including how much the building was offered for sale, lease, or rent by the owner or a previous owner during the period the eligible vacant building was unoccupied.

N/A

PUBLIC BENEFIT INFORMATION

EMPLOYMENT INFORMATION FOR FACILITY TO BE DESIGNATED

ESTIMATE OF EMPLOYEES AND PAYROLL FOR FORT WAYNE FACILITY REQUESTING ECONOMIC REVITALIZATION AREA DESIGNATION

Please be specific on job descriptions. When listing the occupation codes, please avoid using the "Major Occupational Groupings" (i.e. 11-000, 13-000, 15-000, etc.) which are more general in nature. Instead, use specific occupation codes (i.e. 11-1021, 13-1081, 15-2041 etc) for each created and retained job. To fill out information on occupation and occupation code, use data available through Occupation Employment Statistics for Fort Wayne http://www.bls.gov/oes/current/oes_23060.htm

Current Full-Time Employment

Occupation	Occupation Code	Number of Jobs	Total Payroll
Machinist	51-4041	300	\$ 14,761,576
Mechanics	49-9041	107	\$ 5,347,120
Truck & Tractor Ops	53-7051	13	
Salaried		48	\$ 3,767,739

Retained Full-Time Employment

Occupation	Occupation Code	Number of Jobs	Total Payroll	
Machinist	51-4041	300	\$ 14,761,576	
Mechanics	49-9041	107	\$ 5,347,120	
Truck & Tractor Ops	53-7051	13		
Salaried		48	\$ 3,767,739	
Rolling Machine	51-4023	5	\$ 197,600	To be Hired 7/2013 per R-18-12 ERA

Additional Full-Time Employment

Occupation	Occupation Code	Number of Jobs	Total Payroll	REACH EMPLOYMENT DATE
Rolling Machine	51-4023	5	\$ 197,600	ERA 7/2013
Salaried		2	\$ 150,000	> Resolution R-18-12
				> 10/2013

PUBLIC BENEFIT INFORMATION

Current Part-Time or Temporary Jobs

Occupation	Occupation Code	Number of Jobs	Total Payroll
N/A			

Retained Part-Time or Temporary Jobs

Occupation	Occupation Code	Number of Jobs	Total Payroll
N/A			

Additional Part-Time or Temporary Jobs

Occupation	Occupation Code	Number of Jobs	Total Payroll
N/A			

Check the boxes below if the existing jobs and the jobs to be created will provide the listed benefits:

- | | | |
|-----------------------------------------------------------|--------------------------------------------------------|----------------------------------------------------------|
| <input checked="" type="checkbox"/> Pension Plan | <input checked="" type="checkbox"/> Major Medical Plan | <input checked="" type="checkbox"/> Disability Insurance |
| <input checked="" type="checkbox"/> Tuition Reimbursement | <input checked="" type="checkbox"/> Life Insurance | <input checked="" type="checkbox"/> Dental Insurance |

List any benefits not mentioned above:

When will you reach the levels of employment shown above? (month/year): See notes on Page 7

REQUIRED ATTACHMENTS

The following must be attached to the application.

1. **Statement of Benefits Form(s) (first page/front side completed)**
2. **Full legal description of property and a plat map identifying the property boundaries. (Property tax bill legal descriptions are not sufficient.) Should be marked as Exhibit A.**
3. **Check for non-refundable application fee made payable to the City of Fort Wayne.**

ERA filing fee (either real or personal property improvements)	.1% of total project cost not to exceed \$500
ERA filing fee (both real and personal property improvements)	.1% of total project cost not to exceed \$750
ERA filing fee (vacant commercial or industrial building)	\$500
ERA filing fee in an EDTA	\$100
Amendment to extend designation period	\$300
Waiver of non compliance with ERA filing	\$500 + ERA filing fee
4. **Owner's Certificate (if applicant is not the owner of property to be designated)
Should be marked as Exhibit B if applicable.**

CERTIFICATION

I, as the legal taxpayer and/or owner, hereby certify that all information and representations made on this application and its attached exhibits are true and complete and that neither an Improvement Location Permit nor a Structural Permit has been filed for construction of improvements, nor has any manufacturing, research and development, logistical distribution or information technology equipment which is a part of this application been purchased and installed as of the date of filing of this application. I also certify that the taxpayer is not delinquent on any and all property tax due to taxing jurisdictions within Allen County, Indiana. I understand that any incorrect information on this application may result in a rescission of any tax phase-ins which I may receive.

I understand that I must file a correctly completed Compliance with Statement of Benefits Form (CF-1/Real Property for real property improvements and CF-1/PP for personal property improvements) and the Public Benefit Annual Update with the City of Fort Wayne Community Development Division in each year in which I receive a deduction. Further the CF-1/PP form must be filed with the county assessor and the CF-1/Real Property must be filed with the county auditor. Failure to file the CF-1 form with these agencies may result in a rescission of any tax phase-in occurring as a result of this application.

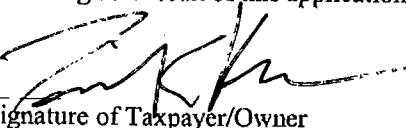
Signature of Taxpayer/Owner

Timothy Kraus, Assistant Treasurer

Printed Name and Title of Applicant

5-1-13

Date

Exhibit "B"

Dana Light Axle Products LLC
2100 W State Blvd
Fort Wayne, Indiana 46808

Applicant is Owner. Owner Certificate is N/A.



STATEMENT OF BENEFITS
PERSONAL PROPERTY

State Form 51764 (R2 / 12-11)
Prescribed by the Department of Local Government Finance

CITY OF...

MAY 06 2013

FORM SB-1 / PP

PRIVACY NOTICE

The cost and any specific individual's salary information is confidential, the balance of the filing is public record per IC 6-1.1-12.1-5.1 (c) and (d).

INSTRUCTIONS:

- 1 This statement must be submitted to the body designating the Economic Revitalization Area prior to the public hearing...
2 Approval of the designating body (City Council, Town Board, County Council, etc.) must be obtained prior to installation...
3 To obtain a deduction, a person must file a certified deduction schedule with the person's personal property return...
4 Property owners whose Statement of Benefits was approved after June 30, 1991, must submit Form CF-1 / PP annually...
5 The schedules established under IC 6-1.1-12.1-4.5(d) and (e) apply to equipment installed after March 1, 2001...

COMMUNITY DEVL.

SECTION 1 TAXPAYER INFORMATION

Name of taxpayer: Dana Light Axle Products LLC
Address of taxpayer: 2100 W State Blvd, Fort Wayne, Indiana
Name of contact person: Cheri Gillum, Analyst
Telephone number: (419) 866-2649

SECTION 2 LOCATION AND DESCRIPTION OF PROPOSED PROJECT

Name of designating body: Fort Wayne Common Council
Location of property: 2100W State Blvd, Fort Wayne, Indiana
County: Allen
DLGF taxing district number: 073 Washington Towns
Description of manufacturing equipment and/or research and development equipment and/or logistical distribution equipment and/or information technology equipment: Manufacturing M&E and Tooling "Exhibit D"
ESTIMATED START DATE: 05/31/2013
ESTIMATED COMPLETION DATE: 04/01/2014

SECTION 3 ESTIMATE OF EMPLOYEES AND SALARIES

Table with 6 columns: Current number, Salaries, Number retained, Salaries, Number additional, Salaries. Values: 468, 23,876,435.00, 468, 23,876,435.00, 2, 150,000.00

SECTION 4 ESTIMATED TOTAL COST AND VALUE OF PROPOSED PROJECT

Table with 4 main categories: MANUFACTURING EQUIPMENT, R & D EQUIPMENT, LOGIST DIST EQUIPMENT, IT EQUIPMENT. Each with COST and ASSESSED VALUE columns.

SECTION 5 WASTE CONVERTED TO OTHER (AS DETERMINED BY THE TAXPAYER)

Estimated solid waste converted (pounds)
Estimated hazardous waste converted (pounds)
Other benefits:

SECTION 6 TAXPAYER CERTIFICATION

I hereby certify that the representations in this statement are true
Signature of authorized person: [Signature]
Title: Assistant Treasurer
Date signed (month, day, year): 5-1-13

FOR RAISE OF THE DESIGNATING BODY

We have reviewed our prior actions relating to the designation of this economic revitalization area and find that the applicant meets the general standards adopted in the resolution previously approved by this body. Said resolution, passed under IC 6-1.1-12.1-2.5, provides for the following limitations as authorized under IC 6-1.1-12.1-2.

A. The designated area has been limited to a period of time not to exceed December 31, 2016 calendar years * (see below). The date this designation expires is December 31, 2016.

- B. The type of deduction that is allowed in the designated area is limited to:
- 1. Installation of new manufacturing equipment; Yes No
 - 2. Installation of new research and development equipment; Yes No
 - 3. Installation of new logistical distribution equipment Yes No
 - 4. Installation of new information technology equipment; Yes No

C. The amount of deduction applicable to new manufacturing equipment is limited to \$ unlimited cost with an assessed value of \$ unlimited.

D. The amount of deduction applicable to new research and development equipment is limited to \$ N/A cost with an assessed value of \$ N/A.

E. The amount of deduction applicable to new logistical distribution equipment is limited to \$ N/A cost with an assessed value of \$ N/A.

F. The amount of deduction applicable to new information technology equipment is limited to \$ N/A cost with an assessed value of \$ N/A.

G. Other limitations or conditions (specify) N/A

H. The deduction for new manufacturing equipment and/or new research and development equipment and/or new logistical distribution equipment and/or new information technology equipment installed and first claimed eligible for deduction on or after July 1, 2000, is allowed for:

- 1 year
- 2 years
- 3 years
- 4 years
- 5 years **
- 6 years
- 7 years
- 8 years
- 9 years
- 10 years **

** For ERA's established prior to July 1, 2000, only a 5 or 10 year schedule may be deducted.

I. Did the designating body adopt an alternative deduction schedule per IC 6-1.1-12.1-17? Yes No
If yes, attach a copy of the alternative deduction schedule to this form.

Also we have reviewed the information contained in the statement of benefits and find that the estimates and expectations are reasonable and have determined that the totality of benefits is sufficient to justify the deduction described above.

Approved: (signature and title of authorized member)
[Signature]
Attested by: [Signature]

Telephone number: (260) 427-1221
Date signed (month, day, year): 5-14-13
Designated body: Common Council

* If the designating body limits the time period during which an area is an economic revitalization area, it does not limit the length of time a taxpayer is entitled to receive a deduction to a number of years designated under IC 6-1.1-12.1-4 5

Exhibit D

Dana Light Axle Products LLC
 2100 W State Blvd
 Fort Wayne, Indiana 46808

Estimated Cost	M&E/ Tooling	Description	Real/Personal	Personal Equipment purchase Date	Personal Installation Date Date	Deprec Years
\$3,225,000.00	M&E	Machinery and Equipment	Personal	May-13	Feb-14	7
\$3,275,000.00	Tooling	Tooling	Personal	May-13	Feb-14	3
\$6,500,000.00	Personal					
\$6,500,000.00	Total					

Dana Light Axle Products LLC
2100 West State Blvd
Fort Wayne, Indiana 46808

— EXHIBIT A —

Parcel I:

The parcels described in Deed Record 384, page 472, Deed Record 384, pages 603-604, Deed Record 406, pages 292-293, together with Lots 1 through 6, inclusive in Poinsett Park Addition (recorded in Plat Book 10, pages 72-73), together with Lots 1 through 44, inclusive in Cambridge Hills Addition (recorded in Plat Book 13, page 61), all as recorded in the Office of the Recorder of Allen County, Indiana, more particularly described as follows:

Beginning at the Southeast Corner of Lot 2 in Poinsett Park Addition, said corner being on the Northerly, 50 foot right-of-way line of West State Boulevard; thence Westerly along said Northerly right-of-way line, a distance of 1,195.52 feet to the Easterly, 60 foot wide transmission right-of-way of Indiana & Michigan Electric Co. (formerly Indiana Service Corporation); thence Northwesterly along said transmission right-of-way, a distance of 282.70 feet to the West line of the Northwest Quarter of Section 34, Township 31 North, Range 12 East, Allen County, Indiana; thence continuing Northwesterly along the Easterly line of said transmission right-of-way, a distance of 2413.8 feet to the North line of the Northeast Quarter of Section 33, Township 31 North, Range 12 East; thence Easterly along the North line of said Northeast Quarter, a distance of 404.7 feet to the Northeast corner of said Section 33, said corner also being the Northwest corner of the Northwest Quarter of said Section 34; thence continuing Easterly along the North line of said Northwest Quarter, a distance of 1063.59 feet to the Northwest corner of the plat of said Cambridge Hills Addition, said corner also being the Northeast corner of the parcel described in Deed Record 384, page 472; thence Southerly along the West line of said Cambridge Hills Addition, said West line also being the East line of the parcel described in Deed Record 384, page 472, a distance of 40 feet to the Northwest corner of Lot 1 in said Cambridge Hills Addition; thence Easterly along the North line of said Lot 1, a distance of 107 feet to the Northeast corner of said Lot 1; thence Southerly along the East lines of Lots 1 through 13, inclusive, in said Cambridge Hills Addition, a distance of 655.28 feet to the Southeast corner of said Lot 13; thence Westerly along the South line of said Lot 13, a distance of 107.68 feet to the Southwest corner of said Lot 13; thence Southerly along the West line of said Cambridge Hills Addition, a distance of 50 feet to the Northwest Corner of Lot 14 in said Cambridge Hills Addition; thence Easterly along the North line of said Lot 14, a distance of 107.74 feet to the Northeast corner of said Lot 14; thence Southerly along the East lines of Lots 14 through 24 inclusive, in said Cambridge Hills Addition, a distance of 570 feet to the Southeast corner of said Lot 24; thence Westerly along the South line of said Lot 24, a distance of 108.4 feet to the Southwest corner of said Lot 24; thence Southerly along the West line of said Cambridge Hills Addition, a distance of 60 feet to the Northwest corner of Lot 25 in said Cambridge Hills Addition; thence Easterly along the North line of said Lot 25, a distance of 108.47 feet to the Northeast corner of said Lot 25; thence Southerly along the East lines of Lots 25 through 41, inclusive, in said Cambridge Hills Addition, a distance of 878 feet to the Southeast corner of said Lot 41; thence Southeasterly, along the east lines of Lots 42, 43, and 44, along a curve to the left, as shown on said plat of Cambridge Hills Addition, a distance of 155.3 feet to the Southeast corner of said Lot 44, said corner being the Northeast corner of Lot 6 in said Poinsett Park Addition; thence Southeasterly, along the East lines of Lots 6 through 2, inclusive, along a curve to the left, as shown on the plat of said Poinsett Park Addition, a distance of 271.91 feet to the Southeast corner of said Lot 2 and the Point of Beginning.

Parcel II:

Lots 78 through 101, inclusive, in Cambridge Hills Addition (recorded in Plat Book 13, page 61 in the Office of the Recorder of Allen County, Indiana), more particularly described as follows:

EXHIBIT A

Beginning at the Southwest corner of Lot 78 in said Cambridge Hills Addition; thence Northerly along the West lines of Lots 78 through 90, inclusive, in said Addition, a distance 657 feet to the Northwest corner of said Lot 90; thence Easterly and Southeasterly, along the Northerly lines of Lots 90 and 91, along a curve to the right, having a radius of 300 feet, an arc length of 232 feet to the Northeast corner of said Lot 91; thence Southerly along the East lines of Lots 91 through 101, inclusive, in said Addition, a distance of 566 feet to the Southeast corner of said Lot 101; thence Westerly, along the South line of said Lot 101, a distance of 118 feet to the Southwest corner of said Lot 101, said corner also being the Northeast corner of Lot 78 in said Addition; thence Southerly, along the East line of said Lot 78, a distance of 50 feet to the southeast corner of said Lot 78; thence Westerly along the south line of said Lot 78, a distance of 110 feet to the Point of the Beginning.

Parcel III:

Lots 126, 127, 128, 133 and 134, together with all of Tillie Avenue lying East of Lots 126, 128, and 133 as vacated by Declaratory Resolution 864-52 and recorded in Plat Book 19, page 162, together with all of vacated Rosemont Drive (Declaratory Resolution 864-52) lying South of Lots 127 and 128, except that portion of vacated Rosemont Drive which lies South of the West 60 feet of Lot 127 and North of the West 60 feet of Lot 133, as sold off in Deed Record 305, page 592, and excepting the West 60 feet of Lots 127, 133 and 134, sold off by Deed Record 305, page 592, and excepting that part of the vacated Tillie Avenue and Lots 126 and 127 sold off for street widening in Deed Record 641, page 583, all lying in the Plat of Eureka Park Addition (recorded in Plat Book 4, page 54, in the Office of the Recorder of Allen County, Indiana) more particularly described as follows:

Beginning at the Southeast corner of Lot 134 in said Eureka Park Addition; thence Westerly along the South line of said Lot 134, distance of 150.37 feet to the Easterly line of the parcel described in Deed Record 305, page 592; thence Northwesterly, along said Easterly line, a distance of 604.57 feet to the southerly right-of-way line of West State Boulevard and the Southwest corner of the parcel described in Deed Record 641, page 583; thence Easterly, along the Southerly right-of-way line, a distance of 340.14 feet to a point on the West line of Lot 125 in said Eureka Park Addition; thence Southerly along the West lines of Lots 125, 129, and 132 in said Eureka Park Addition, a distance of 451.6 feet to the Southwest Corner of Lot 132 in said Addition; thence Westerly, a distance of 50 feet to the Northeast corner of Lot 134 in said Addition; thence Southerly along the East line of said Lot 134 a distance of 136.6 feet to the Point of Beginning.

Being a portion of the property conveyed to Dana Transmissions, Inc., a Delaware corporation by General Warranty Deed dated October 13, 1999, and recorded as Instrument Number 990077849 in the Office of the Recorder of Allen County, Indiana.

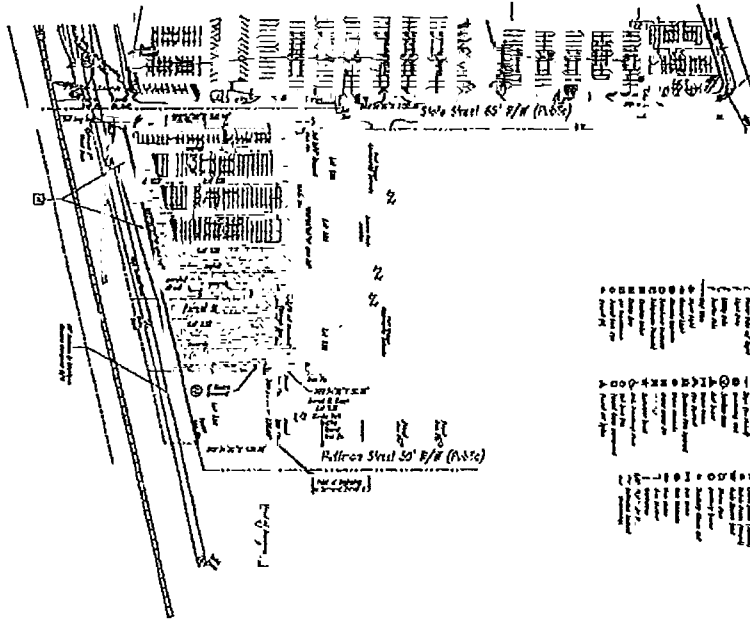

Legend of Symbols & Line - as above

1	Proposed
2	Existing
3	Proposed
4	Proposed
5	Proposed
6	Proposed
7	Proposed
8	Proposed
9	Proposed
10	Proposed
11	Proposed
12	Proposed
13	Proposed
14	Proposed
15	Proposed
16	Proposed
17	Proposed
18	Proposed
19	Proposed
20	Proposed
21	Proposed
22	Proposed
23	Proposed
24	Proposed
25	Proposed
26	Proposed
27	Proposed
28	Proposed
29	Proposed
30	Proposed
31	Proposed
32	Proposed
33	Proposed
34	Proposed
35	Proposed
36	Proposed
37	Proposed
38	Proposed
39	Proposed
40	Proposed
41	Proposed
42	Proposed
43	Proposed
44	Proposed
45	Proposed
46	Proposed
47	Proposed
48	Proposed
49	Proposed
50	Proposed

SCALE: 1" = 100'
 0 10 20 30 40 50 60 70 80 90 100

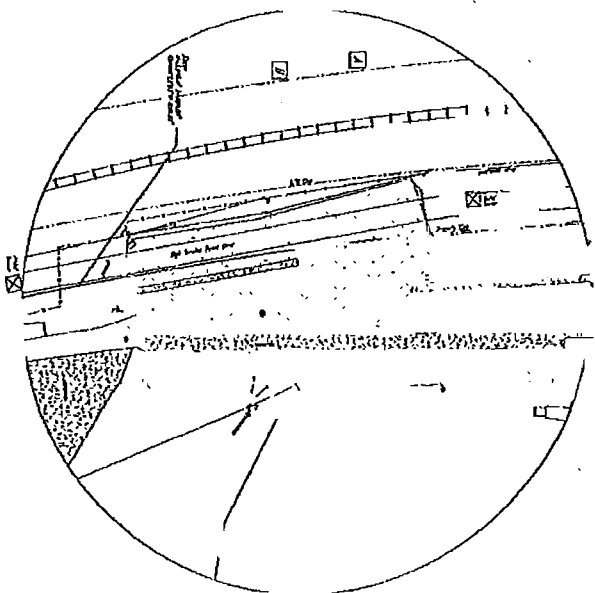

Detail 2'

ALYAKSH LAND TITLE SURVEY
 Done Pursuant to Order
 of the Court
 in Case No. 10-2007
 dated 11/11/07



Bock & Clark's National Surveyors Network
 National Coordinators of ALTA/ACSM Land Title Surveys
 117 1/2 W. Duane Street, Suite 100, Portland, OR 97201
 Phone: (503) 325-1111 Fax: (503) 325-1112 www.bcn.net

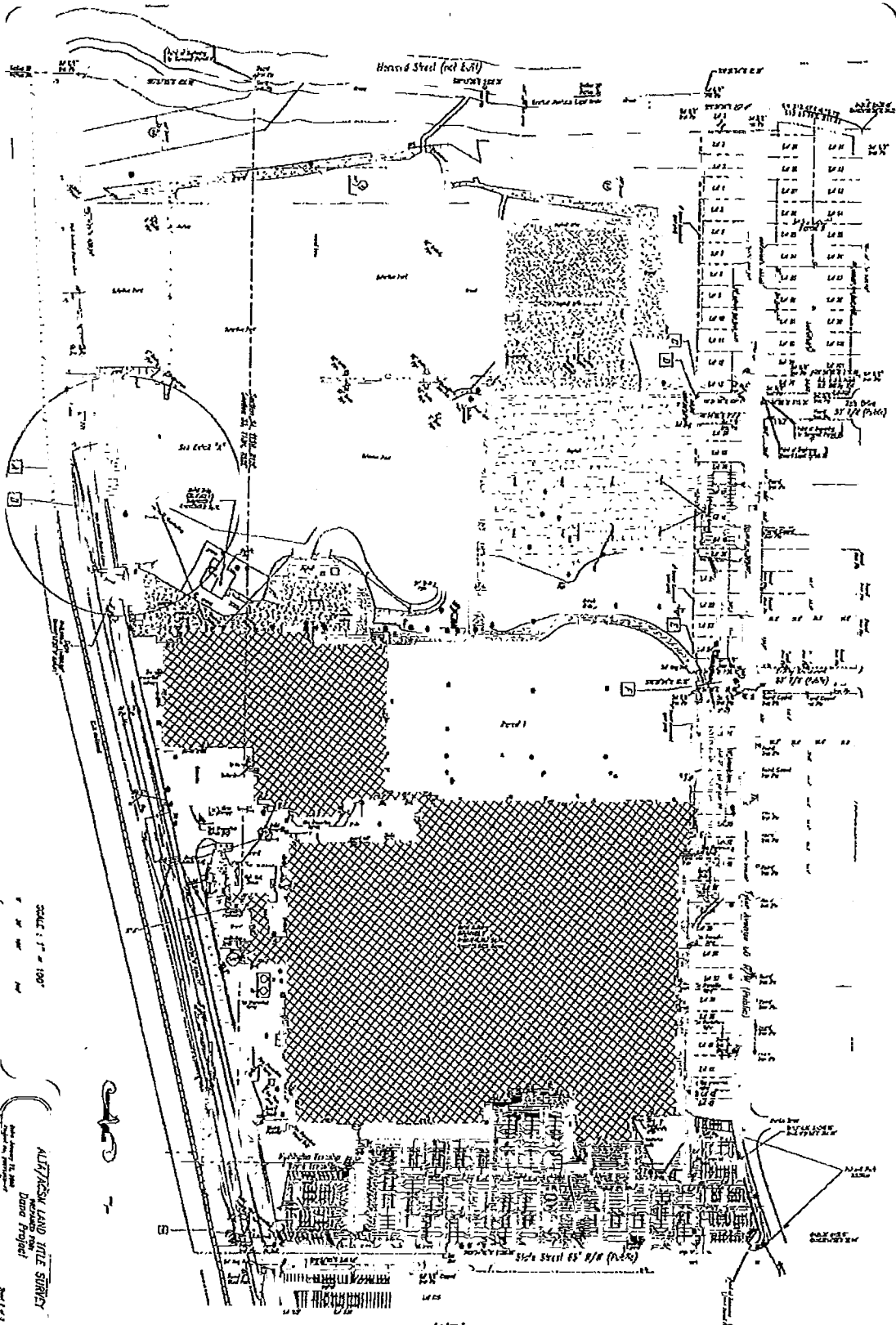

Bock & Clark's National Surveyors Network
 National Coordinators of ALTA/ACSM Land Title Surveys
 511 North Capitol Mall, Suite 4000
 Sacramento, CA 95814
 Phone (916) 441-1111 Fax (916) 441-1112

Exhibit "C"

Dana Light Axle Products LLC
2100 W State Blvd
Fort Wayne, Indiana 46808

Real Estate Property	Personal Property
Parcel Number	Parcel Number
02-07-33-229-002.000-073	073-0014179
02-07-34-101-001.000-073	
02-07-34-101-002.000-073	
02-07-34-126-001.000-074	
02-07-34-126-002.000-074	
02-07-34-126-003.000-074	
02-07-34-126-004.000-074	
02-07-34-126-005.000-074	
02-07-34-126-006.000-074	
02-07-34-126-007.000-074	
02-07-34-126-008.000-074	
02-07-34-126-009.000-074	
02-07-34-126-010.000-074	
02-07-34-126-011.000-074	
02-07-34-126-012.000-074	
02-07-34-126-013.000-074	
02-07-34-126-014.000-074	
02-07-34-126-015.000-074	
02-07-34-126-016.000-074	
02-07-34-126-017.000-074	
02-07-34-126-018.000-074	
02-07-34-126-019.000-074	
02-07-34-126-020.000-074	
02-07-34-126-021.000-074	
02-07-34-126-022.000-074	
02-07-34-126-023.000-074	
02-07-34-126-024.000-074	
02-07-34-151-001.000-074	
02-07-34-151-002.000-074	
02-073-0012936/008582	

Admn. Appr.

DIGEST SHEET

TITLE OF ORDINANCE: **Declaratory Resolution**

DEPARTMENT REQUESTING ORDINANCE: **Community Development Division**

SYNOPSIS OF ORDINANCE: **Dana Light Axle Products, LLC is requesting the designation of an Economic Revitalization Area for personal property improvements in the amount of \$6,500,000. In order to expand, Dana Light Axle Products, LLC will add \$6,500,000 of manufacturing equipment.**

EFFECT OF PASSAGE: **Installing the new equipment will allow Dana Light Axle Products, LLC to maintain their market position. Two full-time jobs will be created.**

EFFECT OF NON-PASSAGE: **Potential loss of development and two full-time jobs**

MONEY INVOLVED (DIRECT COSTS, EXPENDITURES, SAVINGS): **No expenditures of public funds required.**

ASSIGNED TO COMMITTEE (PRESIDENT): **John Crawford and Tom Smith**

MEMORANDUM

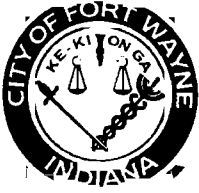

TO: City Council
FROM: Adam Welch, Economic Development Specialist
DATE: May 7, 2013
RE: Request for designation by Dana Light Axle Products, LLC as an ERA for personal property improvements

BACKGROUND

PROJECT ADDRESS: **2100 W. State Blvd.** PROJECT LOCATED WITHIN: **Not Applicable**
 PROJECT COST: **\$ 6,500,000** COUNCILMANIC DISTRICT: **3**

COMPANY PRODUCT OR SERVICE: **Dana Light Axle Products, LLC is an automobile parts manufacturer.**
 PROJECT DESCRIPTION: **Dana Light Axle Products, LLC will purchase and install new manufacturing equipment.**

CREATED		RETAINED	
JOBS CREATED (FULL-TIME):	2	JOBS RETAINED (FULL-TIME):	468
JOBS CREATED (PART-TIME)	0	JOBS RETAINED (PART-TIME)	0
TOTAL NEW PAYROLL:	\$150,000	TOTAL RETAINED PAYROLL:	\$ 23,876,435
AVERAGE SALARY (FULL-TIME NEW):	\$75,000	AVERAGE SALARY (FULL-TIME RETAINED)	\$ 51,018

COMMUNITY BENEFIT REVIEW

Yes No N/A

Project will encourage vacant or under-utilized land appropriate for commercial or industrial use?

Yes No N/A

Real estate to be designated is consistent with land use policies of the City of Fort Wayne?

Explain: Property to be designated is zoned IN3; Heavy Industrial Zoning Class

Yes No N/A

Project encourages the improvement or replacement of a deteriorated or obsolete structure?

Yes No N/A

Project encourages the improvement or replacement of obsolete manufacturing and or research and development and or information technology and or logistical distribution equipment?

Yes No N/A

Project will result in significant conversion of solid waste or hazardous waste into energy or other useful products?

Yes No N/A

Project encourages preservation of an historically or architecturally significant structure?

Yes No N/A

Construction will result in Leadership in Energy and Environmental Design (LEED) certification by the U.S. Green Building Council?

Yes No N/A

Construction will use techniques to minimize impact on combined sewer overflows? (i.e. rain gardens, bio swales, etc.)

Yes No N/A

ERA designation induces employment opportunities for Fort Wayne area residents?

Yes No N/A

Taxpayer is NOT delinquent on any or all property tax due to any taxing jurisdiction within Allen County.

POLICY

Per the policy of the City of Fort Wayne, the following guidelines apply to this project:

1. The period of deduction for personal property is ten years.

Under Fort Wayne Common Council's tax abatement policies and procedures, Dana Light Axle Products, LLC is eligible for a ten year deduction on personal property improvements. Attached is a spreadsheet that shows how the application scored under the review system. Also attached is an estimate of the taxes saved and paid over the length of the ten year deduction schedule.

COMMENTS

Signed:

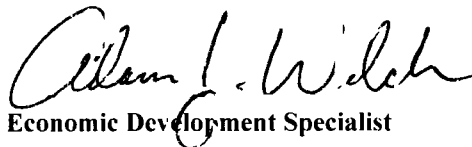
Economic Development Specialist

Reviewed:

Economic Development Specialist

COMMUNITY DEVELOPMENT DIVISION

Personal Property Abatements

Tax Abatement Review System

	Points Possible	Points Awarded
INVESTMENT (20 points possible)		
Total new investment in equipment		
Over \$5,000,000	10	10
\$1 000,000 to \$4,999,999	8	
\$500,000 to \$999,999	6	
\$0 to \$499,999	4	
Investment per employee (both jobs created and retained)		
\$35,000 or more	10	
\$18,500 to \$34,999	8	
\$6,250 to \$18,499	6	6
\$1,250 to \$6 249	4	
less than \$1 250	2	
Estimated local income taxes generated from jobs retained		
\$80,000 or more	5	5
\$30,000 to \$79,999	4	
\$10,000 to \$29,999	3	
\$5,000 to \$9,999	2	
less than \$5,000	1	
Estimated local income taxes generated from jobs created (Double points for start-up)		
\$30 000 or more	5	
\$10,000 to \$29,999	4	
\$5,000 to \$9,999	3	
\$3,000 to \$4,999	2	
less than \$3,000	1	1
ECONOMIC BASE (20 points possible)		
Location Quotient in designated Occupation Code (use majority Occupation Code of all created and retained jobs)		
Greater than 1 0	5	5
Estimated Percent of Business done outside Allen County		
Greater than 75%	15	15
50% to 74%	10	
25% to 49%	5	
JOBS (20 points possible)		
Total number of permanent jobs retained		
Over 250	10	10
100 to 249	8	
50 to 99	6	
25 to 49	4	
10 to 24	2	
1 to 9	1	
Total number of permanent jobs created (Double for start-up)		
Over 100	10	
50-99	8	
25-49	6	
10-24	4	
1 to 9	2	2
WAGES (20 points possible)		
Median salary of the full time jobs created and/or retained		
Over \$45,000	20	20
\$40,000 to \$44,999	16	
\$35,000 to \$39,999	12	
\$30,000 to 34,999	8	
\$25,000 to \$29,999	4	
under \$25,000	0	

BENEFITS (10 points possible)

Major Medical Plan	7	7
Pension, Tuition Reimbursement, Life Insurance, Dental Insurance, Disability Insurance,	3	3

SUSTAINABILITY

Construction uses green building techniques (ie LEED Certification)	5
Construction uses techniques to minimize impact on Combined Sewer Overflows (CSOs)	5

Total 84

Length of Abatement

- 20 to 39 points - 3 year abatement
- 40 to 59 points - 5 year abatement
- 60 to 69 points - 7 year abatement
- 70 to 100 points - 10 year abatement

* If Average annual salary of the full-time jobs created by listed occupation is 10% or greater than the average salary for Allen County using current occupational employment statistics, then the applicant is eligible for an alternate deduction schedule.

Personal Property - 11 Job Schedules

<p>10 year</p> <p>Year 1 100%</p> <p>Year 2 90%</p> <p>Year 3 80%</p> <p>Year 4 70%</p> <p>Year 5 60%</p> <p>Year 6 50%</p> <p>Year 7 40%</p> <p>Year 8 30%</p> <p>Year 9 20%</p> <p>Year 10 10%</p> <p>Year 11 0%</p> <p>7 year</p> <p>Year 1 100%</p> <p>Year 2 85%</p> <p>Year 3 71%</p> <p>Year 4 57%</p> <p>Year 5 43%</p> <p>Year 6 29%</p> <p>Year 7 14%</p> <p>Year 8 0%</p> <p>5 year</p> <p>Year 1 100%</p> <p>Year 2 80%</p> <p>Year 3 60%</p> <p>Year 4 40%</p> <p>Year 5 20%</p> <p>Year 6 0%</p> <p>3 year</p> <p>Year 1 100%</p> <p>Year 2 66%</p> <p>Year 3 33%</p> <p>Year 4 0%</p>	<p>10 Year</p> <p>Year 1 100%</p> <p>Year 2 100%</p> <p>Year 3 100%</p> <p>Year 4 100%</p> <p>Year 5 100%</p> <p>Year 6 90%</p> <p>Year 7 80%</p> <p>Year 8 65%</p> <p>Year 9 50%</p> <p>Year 10 40%</p> <p>7 Year</p> <p>Year 1 100%</p> <p>Year 2 100%</p> <p>Year 3 100%</p> <p>Year 4 100%</p> <p>Year 5 100%</p> <p>Year 6 71%</p> <p>Year 7 43%</p>
----------------------------------------------------------------------------------------------------------------------------------------------------------------------------------------------------------------------------------------------------------------------------------------------------------------------------------------------------------------------------------------------------------------------------------------------------------------------------------------------------------------------------------------------------------------------------------------------------------------------------------	-------------------------------------------------------------------------------------------------------------------------------------------------------------------------------------------------------------------------------------------------------------------------------------------------------------------------------------------------------------------------

**POOL #2 FORT WAYNE COMMUNITY DEVELOPMENT DIVISION
TAX ABATEMENT - ESTIMATE OF SAVINGS**

*New tax abatement percentages have been changed to reflect change in state law

PERSONAL PROPERTY TAX ABATEMENT - 10 yr Schedule

Year	True Cash Value	"Pool 2"	True Tax Value	Assessed Value	Tax Abatement %	Tax Paid %	Deduction	Taxable A V	Tax Rate	Tax Paid	Tax Saved
1	\$6,500,000	40%	\$2,600,000	\$2,600,000	100%	0%	\$2,600,000	\$0	0.033124	\$0	\$86,122
2	\$6,500,000	56%	\$3,640,000	\$3,640,000	90%	10%	\$3,276,000	\$364,000	0.033124	\$12,057	\$108,514
3	\$6,500,000	42%	\$2,730,000	\$2,730,000	80%	20%	\$2,184,000	\$546,000	0.033124	\$18,086	\$72,343
4	\$6,500,000	32%	\$2,080,000	\$2,080,000	70%	30%	\$1,456,000	\$624,000	0.033124	\$20,669	\$48,229
5	\$6,500,000	30%	\$1,950,000	\$1,950,000	60%	40%	\$1,170,000	\$780,000	0.033124	\$25,837	\$38,755
6	\$6,500,000	30%	\$1,950,000	\$1,950,000	50%	50%	\$975,000	\$975,000	0.033124	\$32,296	\$32,296
7	\$6,500,000	30%	\$1,950,000	\$1,950,000	40%	60%	\$780,000	\$1,170,000	0.033124	\$38,755	\$25,837
8	\$6,500,000	30%	\$1,950,000	\$1,950,000	30%	70%	\$585,000	\$1,365,000	0.033124	\$45,214	\$19,378
9	\$6,500,000	30%	\$1,950,000	\$1,950,000	20%	80%	\$390,000	\$1,560,000	0.033124	\$51,673	\$12,918
10	\$6,500,000	30%	\$1,950,000	\$1,950,000	10%	90%	\$195,000	\$1,755,000	0.033124	\$58,133	\$6,459
11	\$6,500,000	30%	\$1,950,000	\$1,950,000	0%	100%	\$0	\$1,950,000	0.033124	\$64,592	\$0
							TOTAL TAX SAVED		(10 yrs on 10 yr deduction		\$450,851
							TOTAL TAX PAID		(10 yrs on 10 yr deduction		\$302,720

Public Hearing Date, if applicable

Read the first time in full and on motion by Councilman *John Crawford*,
Read the second time by title and referred to the *Finance Committee*,
Committee. Read the third time in full and on motion by Councilman
Crawford, placed on passage by the following vote:

	AYES	NAYS	ABSTAINED	ABSENT
TOTAL VOTES	9			
BENDER	✓			
CRAWFORD	✓			
DIDIER	✓			
HARPER	✓			
HINES	✓			
JEHL	✓			
PADDOCK	✓			
SHOAFF	✓			
SMITH	✓			

DATED: *5-14-13* *Sandra E. Kennedy*
SANDRA E. KENNEDY, CITY CLERK

Passed and adopted by the Common Council of the City of Fort Wayne, Indiana, as
(ANNEXATION) (APPROPRIATION) (GENERAL) (SPECIAL) (ZONING), ~~FINANCE~~
(RESOLUTION) NO. *R-47-13* on the *14th* day of
May, 2013

ATTEST:
Sandra E. Kennedy
SANDRA E. KENNEDY,
CITY CLERK

T. Thomas Didier
PRESIDING OFFICER

Presented by me to the Mayor of the City of Fort Wayne, Indiana, on the *20th* day
of *May*, 2013, at the hour of *1:00* o'clock *P.M.* .E.S.T.

Sandra E. Kennedy
SANDRA E. KENNEDY, CITY CLERK

Approved and signed by me this *20th* day of *MAY*
2013, at the hour of *2:00* o'clock *PM* .E.S.T.

Thomas C. Henry
THOMAS C. HENRY, MAYOR

BILL NO R-13-05-09

**REPORT OF THE COMMITTEE ON FINANCE
MAY 14, 2013**

**JOHN CRAWFORD – CHAIR
TOM SMITH – CO-CHAIR
ALL COUNCIL MEMBERS**

WE, YOUR COMMITTEE ON FINANCE TO WHOM WAS REFERRED A DECLARATORY RESOLUTION designating an "Economic Revitalization Area" under I.C. 6-1.1-12.1 for property commonly known as 2100 W. State Blvd., Fort Wayne, Indiana 46808 (Dana Light Axle Products, LLC) COMMITTEE OF FINANCE HAVE HAD SAID ORDINANCE UNDER CONSIDERATION AND BEG LEAVE TO REPORT BACK TO THE COMMON COUNCIL THAT SAID ORDINANCE

DO PASS DO NOT PASS ABSTAIN NO REC

John Crawford
Tom Smith
James F. Dineen
Monte D. Bial
[Other illegible signatures]

Glynn Dines - vote d.d.n.i vote

SANDRA E. KENNEDY
CITY CLERK